



Project: \_\_\_\_\_  
 Location: \_\_\_\_\_  
 Item #: \_\_\_\_\_  
 Quantity: \_\_\_\_\_

## Back Bar Cooler

### VBB MODELS —

Textured, Black Steel Exterior with Stainless Steel Counter Top and Interior Floor. Galvanized Steel Interior Walls.

**VBB-48-B-B**

**VBB-60-B-B**

**VBB-72-B-B**



**VBB-60-B-B**

### Standard Features

- Available In Even Increments of 48", 60" and 72" Widths
- Self-Contained, Capillary Tube Refrigeration System Uses Environmentally Friendly R-134a Refrigerant
- Sleek, Modern Exterior Design
- Extremely Durable Textured, Black Steel Exterior with a Stainless Steel Countertop
- Heavy-Duty Reinforced Stainless Steel Floor with Galvanized Steel Walls and Ceiling
- Threshold Sills are Reinforced with Heavy Gauge Stainless Steel
- Doors Have Replaceable One-Piece Magnetic Perimeter Gaskets with a Positive Assist Door Closer
- Each Door Has a Cylinder Lock, and Easy Grip Handle
- Two Heavy-Duty Epoxy Coated Shelves are Provided Per Door Section
- Shelves Adjustable on 3/4" Increments
- Bright Fluorescent Interior Lighting is Safety Shielded
- An Average of More Than 2" of Energy Saving, High Density, Polyurethane Insulation Throughout the Cabinet
- Automatic, Non-Electric Condensate Disposal System

- High Efficiency, Quiet Running, Side-Mounted Refrigeration System
- Unique Air Distribution System Chills Product Evenly and Quickly
- "Front Breathing" Design Allows Cabinet to be Recessed
- Refrigeration System Slides Out Providing Easy Access
- Operating Temperature Range 34°F to 38°F
- Listed Under NSF-7 For the Storage and/or Display of Packaged and Bottled Products
- Two-Year Warranty on Parts and Labor and a Five-Year Warranty on the Compressor (U.S.A. only)
- Cord and Plug

### Optional Features and Accessories

- 6" Adjustable Stainless Steel Legs
- 5" Casters (2 Swivel, 2 with Brakes)
- 3" Casters (2 Swivel, 2 with Brakes)
- Extra Shelves
- Stainless Steel Models (Exterior)
- Low E, Tempered, Double Pane Glass Doors with Black or Stainless Steel Frames

Approvals:



Victory Refrigeration specification sheets are available online at [www.victory-refrig.com](http://www.victory-refrig.com).

CHARACTERISTICS	VBB-48-B-B	VBB-60-B-B	VBB-72-B-B
Width, Overall	48"	60"	72"
Depth, Overall	24"	24"	24"
Height, Overall	36"	36"	36"
Number of Doors	2	2	3
Number of Shelves	4	4	6
Refrigerant	R-134a	R-134a	R-134a
Cabinet Voltage	115/60/1	115/60/1	115/60/1
Condensing Unit Size (HP)	1/4	1/3	1/3
Total Amperes	7.1	8.1	8.1

crated dim. & wts.	Ht.	Width	Depth	Lbs
VBB-48-B-B	45	56	34	265
VBB-60-B-B	45	78	34	330
VBB-72-B-B	45	78	34	380

Dimensional tolerance  $\pm 1/4"$  Metric dimensions (MM)

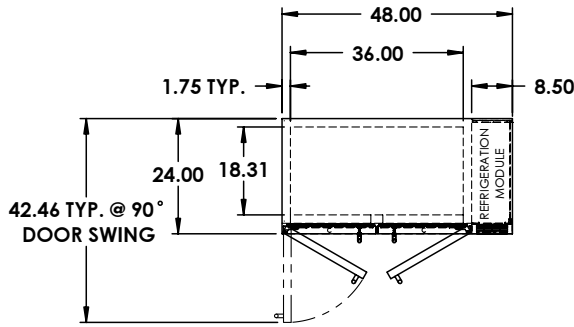

VBB-48-B-B

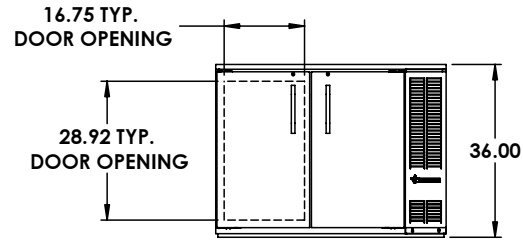

FRONT ELEVATION

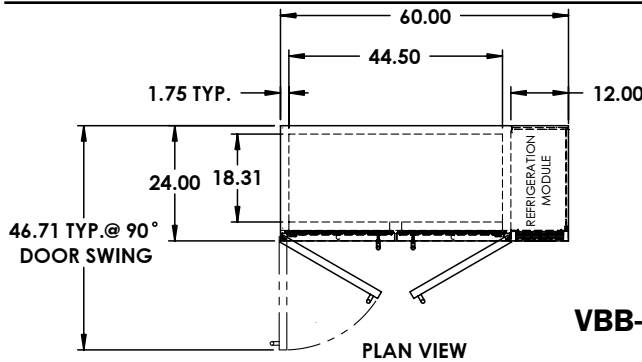

VBB-60-B-B

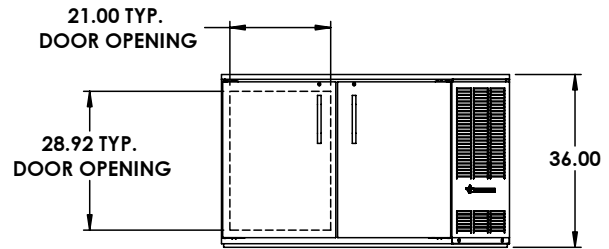

FRONT ELEVATION

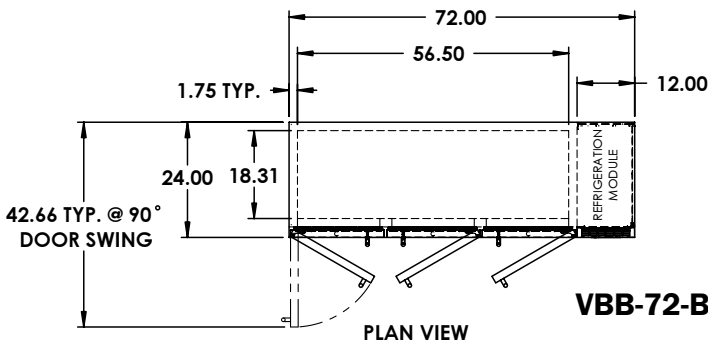

VBB-72-B-B

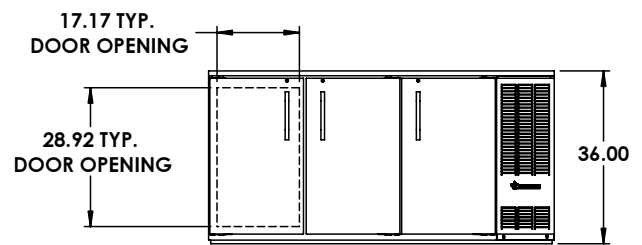

FRONT ELEVATION

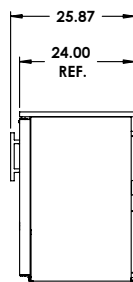

Side View  
All Models

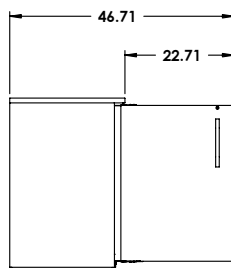

VBB-60-B-B

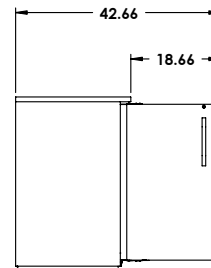

VBB-48-B-B & VBB-72-B-B

Continuous product development may necessitate specification changes and design without notice.



Victory participates in the KCL CADalog, the most current source of CAD symbols for foodservice designers worldwide. Symbols include standard equipment in plan, side, front and 3-D views, layered for FEDA/FCSI recommended guidelines.